



危险!

危险电压

- ▶ 断开高压系统后至少5分钟内电源插头仍然带电。

可能引起的后果:

- ▶ 触碰电源端子可能会引起严重的人身伤害甚至死亡。

保护措施:

- ▶ 关掉高压系统并等待至少5分钟后方可工作于该设备。
- ▶ 确保所有电源端子均不带电。

更多信息请至如下网址下载区查找

www.bucherdrives.com

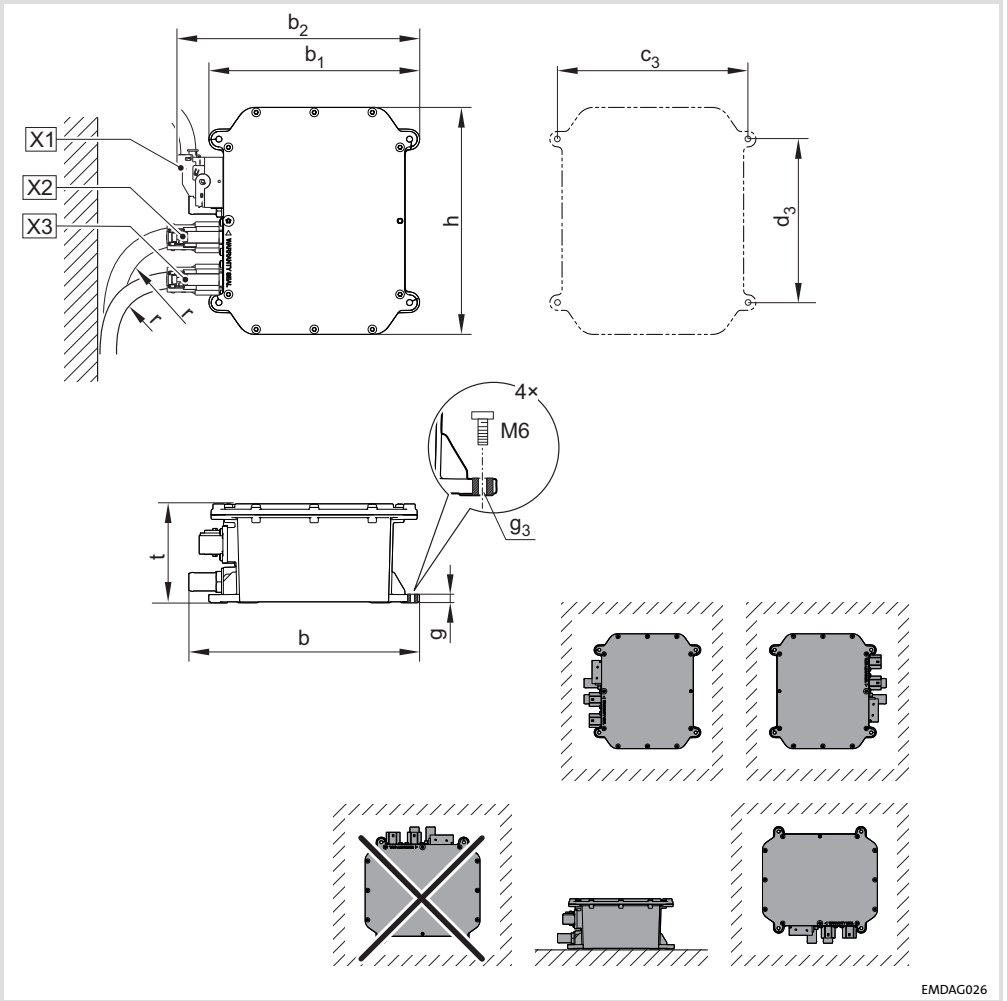

EMDAG026

	h	b	t	b ₁	b ₂	c ₃	d ₃	g	g ₃	r	⊞
	[mm]										
EMDxG5...	250	254	109	232	237	210	180	9	∅ 6.7	106	3.9



4

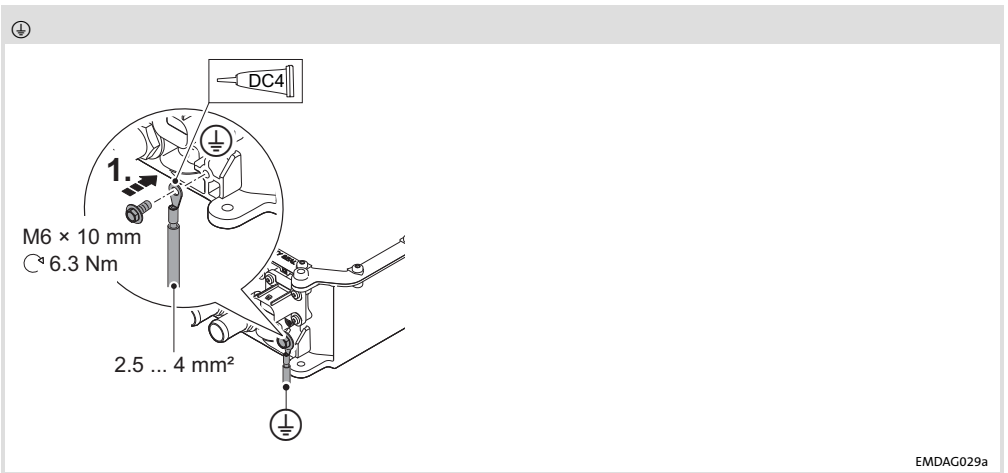
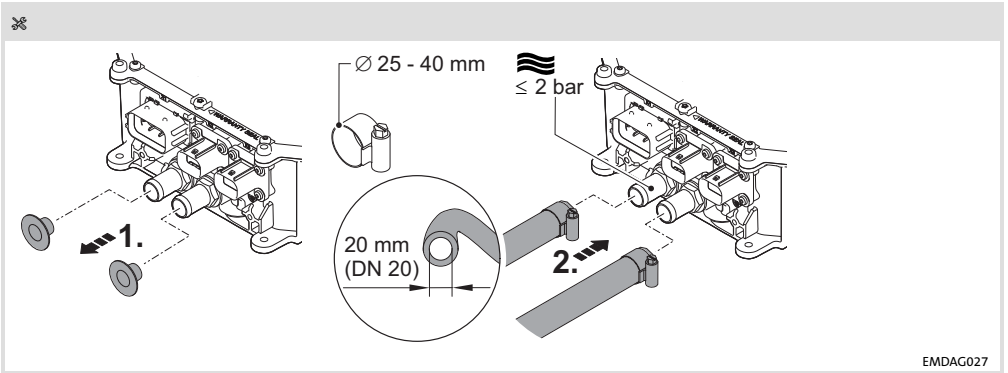

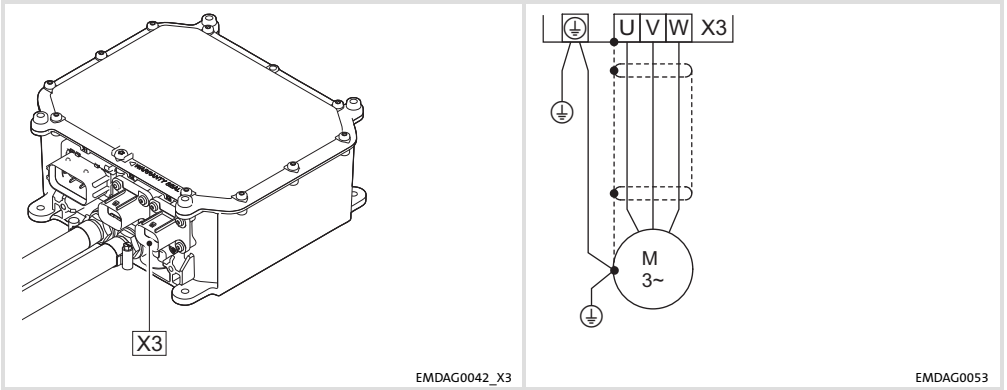

EMDAG0042_X3

EMDAG0053

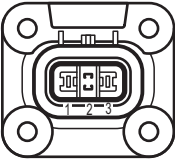
X3			U_{max}	
			[V AC]	[mm ²] [AWG]
	1	U	600	2.5 ... 4 12 ... 10
	2	V		
	3	W		

EMDAG049c

D



Den Schutzleiter zwischen Motor und DC/AC-Wechselrichter parallel zur Motorleitung verlegen. Bei fehlendem Schutzleiter wird im Fehlerfall der Schirm der Motorleitung überlastet.

GB



Lay the PE conductor between the motor and the DC/AC inverter parallel to the motor cable. If the PE conductor is missing, the shield of the motor cable is overloaded in the event of an error.

F



Le conducteur de protection entre le moteur et le convertisseur CC/CA doit être posé parallèle au câble moteur. En l'absence d'un conducteur de protection, le blindage du câble moteur sera surchargé en cas de défaut.

E



Tender el conductor de protección entre el motor y el inversor de CC/CA en paralelo al cable del motor. Si hay una avería y falta el conductor de protección, la pantalla del cable del motor se sobrecarga.

RC



将PE导线置于电机和DC/AC变频器之间，与电机电缆并联。如果缺少PE导线，电机电缆的屏蔽会在发生错误时过载。

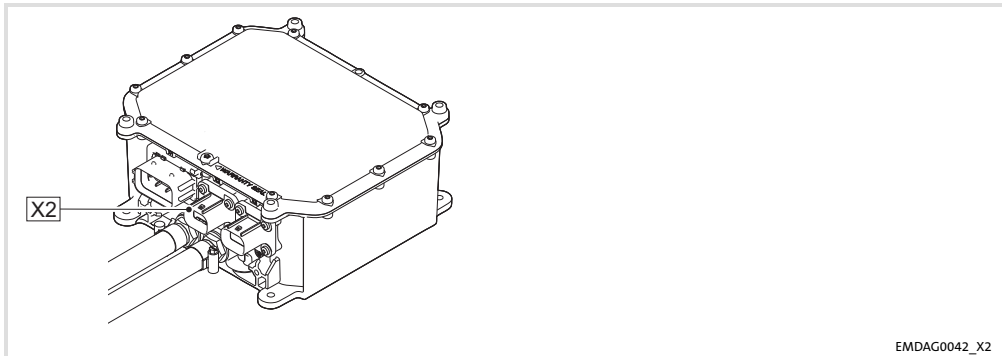

EMDAG0042_X2

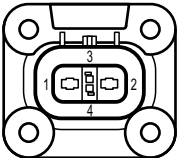
X2		U_{max}		
		[V DC]	[mm ²] [AWG]	
 <p>EMDAG049b</p>	1	+UG	848	2.5 ... 4 12 ... 10
	2	-UG		
	3	InterLock1		0.5 ... 0.75 20 ... 18
	4	InterLock2		

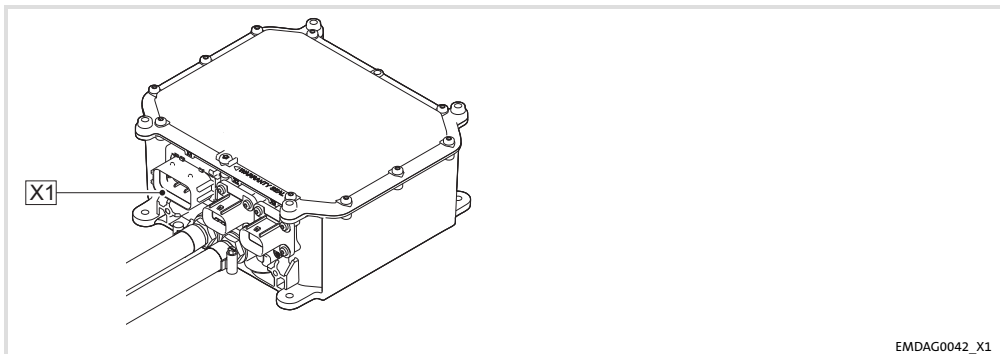

EMDAG0042_X1

X1

[mm²]
[AWG]

d [mm]

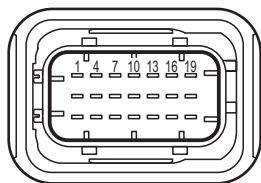

EMDAG049a

1	CAN_H	12	FLX_IN3
2	CAN_L	13	n.c.
3	CAN_L_TERM	14	n.c.
4	n.c.	15	KL31
5	TEMP_MA+	16	FLX_IN1
6	TEMP_MA-	17	FLX_IN2
7	KL15	18	ID_PIN1
8	KL30	19	ID_PIN2
9	CAN_H	20	ID_PIN3
10	CAN_L	21	n.c.
11	FLX_IN4		

0.5 ... 1.25
20 ... 16

1.2 ... 2.1



Publisher

Bucher Hydraulics AG
Mobile Drives
Obere Neustrasse 1
CH 8590 Romanshorn

Phone +41 41 757 03 33

Email info.ch@bucherdrives.comInternet www.bucherdrives.com

Service

Lenze Service GmbH
Breslauer Straße 3
DE-32699 Extertal
Germany

Phone 0080002446877 (24 h helpline)

Email service@lenze.com